



2023 BAHRAIN GRAND PRIX

03 - 05 March 2023

From	The FIA Formula One Race Director	Document	3
To	All Teams, All Officials	Date	02 March 2023
		Time	14:20

Title Event Notes - Red Zone and Pirelli Preview

Description Red Zone and Pirelli Preview A

Enclosed BHR DOC 3 - Event Notes - Red Zone and Pirelli Preview.pdf

Niels Wittich

The FIA Formula One Race Director



FORMULA 1 GULF AIR SAUDI ARABIA GRAND PRIX 2023 - SAKHIR

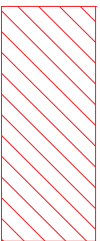
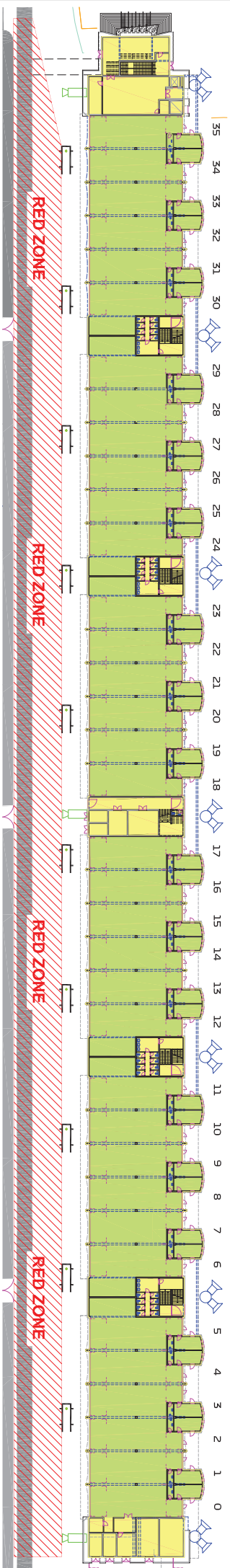

PHOTOGRAPHERS EXCLUSION RED ZONE

This drawing should also be used for Bahrain Test
FORMULA 1 ARAMCO PRE-SEASON TESTING 2023

Grand Prix of Bahrain 03/03-05/03/2023 (23R01BAH)

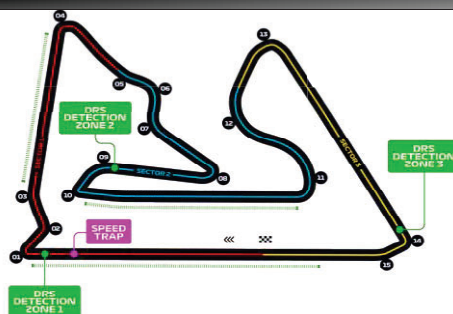

Compounds selection

Compound	FL	FR	RL	RR	Mandatory race tyres
C1	1K1	1K2	1K3	1K4	C1
C2	2L1	2L2	2L3	2L4	C2
C3	3N1	3N2	3N3	3N4	C3
Intermediate	9G1	9G2	9G3	9G4	Q3 tyre
Wet	95B	96B	97B	98B	C3

Prescriptions

Pressures & camber

	Minimum starting pressure			Expected stabilized running pressure	Camber limit
	Slicks	Intermediate	Wet		
Front	21.0 psi	21.0 psi	20.0 psi	≥23.0 psi	-3.50°
Rear	18.5 psi	18.5 psi	17.5 psi	≥20.5 psi	-2.00°

Cold Pressure Cooling Curve

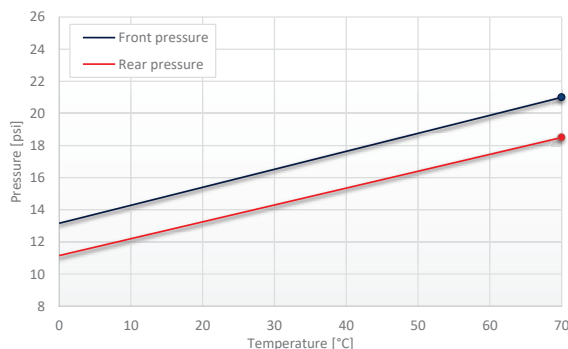

$$P_{front} = (T - 70) \cdot 0.112 + P_{startf}$$

$$P_{rear} = (T - 70) \cdot 0.105 + P_{startr}$$

P_{startf} : Minimum starting pressure on the front axle [psi]

P_{startr} : Minimum starting pressure on the rear axle [psi]

T : Tyre temperature [°C]

Maximum heating times and temperatures (tread & sidewall)

Temperature	0	40	60	70 (°C)
Slicks	max. 2h			
Intermediate	max. 2h			
Wet	max. 2h			

• Temperatures refer to tyre tread and side wall temperatures, not blanket or controller set-point temperatures.

• Tyres may only be heated prior to the session in which they are intended to be used.

• The temperatures apply at all times during the event.

Tyres notes

- Not permitted to switch tyres from their originally allocated position.
- Do not subject tyres to large deformation or heavy impact.
- Do not leave fitted tyres exposed at an air temperature lower than 10°C and/or any excessive UV emission.
- Revised prescriptions could be issued during the race weekend in accordance with TD003.
- Heating time temperature limits apply to the actual tyre surface temperature measured with the IR gun as detailed in the TD003
- Cold cooling curve temperature limits apply to the tyre side wall temperature measured with the probe as detailed in TD003
- BLANKET HEATING TIME for each temperature range to be counted from the moment the blanket control unit is set to reach its targeted temperature within its correspondent interval.

General notes

Teams are kindly reminded that the following will be subject to FIA checks during the event:

- Starting pressures
- Cold pressures (according to the cold pressure cooling curves)
- Re-heat pressures
- EOS Camber
- Maximum tyre temperatures and times in blankets
- Tyre swapping